



Requirements for Site Plans

The following information is required on all sites plans submitted to Londonderry Township as part of a permit application review, this criteria is taken from Section 27-422 Site Plan Requirements from the Zoning Ordinance of the Londonderry Township Code of Ordinances.

All site plans should be drawn to scale and be eligible, Scale should reasonable and easily read on an standard 8.5x11 sheet of graph paper, two paper copies and a digital copy of site plans should be submitted with any application

- 1 Location and dimensions to all property lines
- 2 Lot area in square feet or acres
- 3 Location and identification of any floodplain areas
- 4 Location and identificatiotin of any easements or right-of-way
- 5 Idenification of all setback lines and the required distances
- 6 Location, dimensions, and square footage of all existing structures - including sheds and pools
- 7 Location, dimensions, and square footage of all sidewalks, driveways, patios, and other impervious areas
- 8 Location and idenification of all on lot sewage disposal systems and fresh water wells
- 9 Location and identification of all stormwater management areas and facilites
- 10 Location, dimension, and square footage of all proposed work or activity

Any questions regarding the requirements of site plan and permit application submissons should be submitted to the Londonderry Township Codes Department at 717-944-1803 or BCO@londonderry.org

SITE PLAN EXAMPLE 1 BUILDING AND ZONING PERMIT APPLICATION

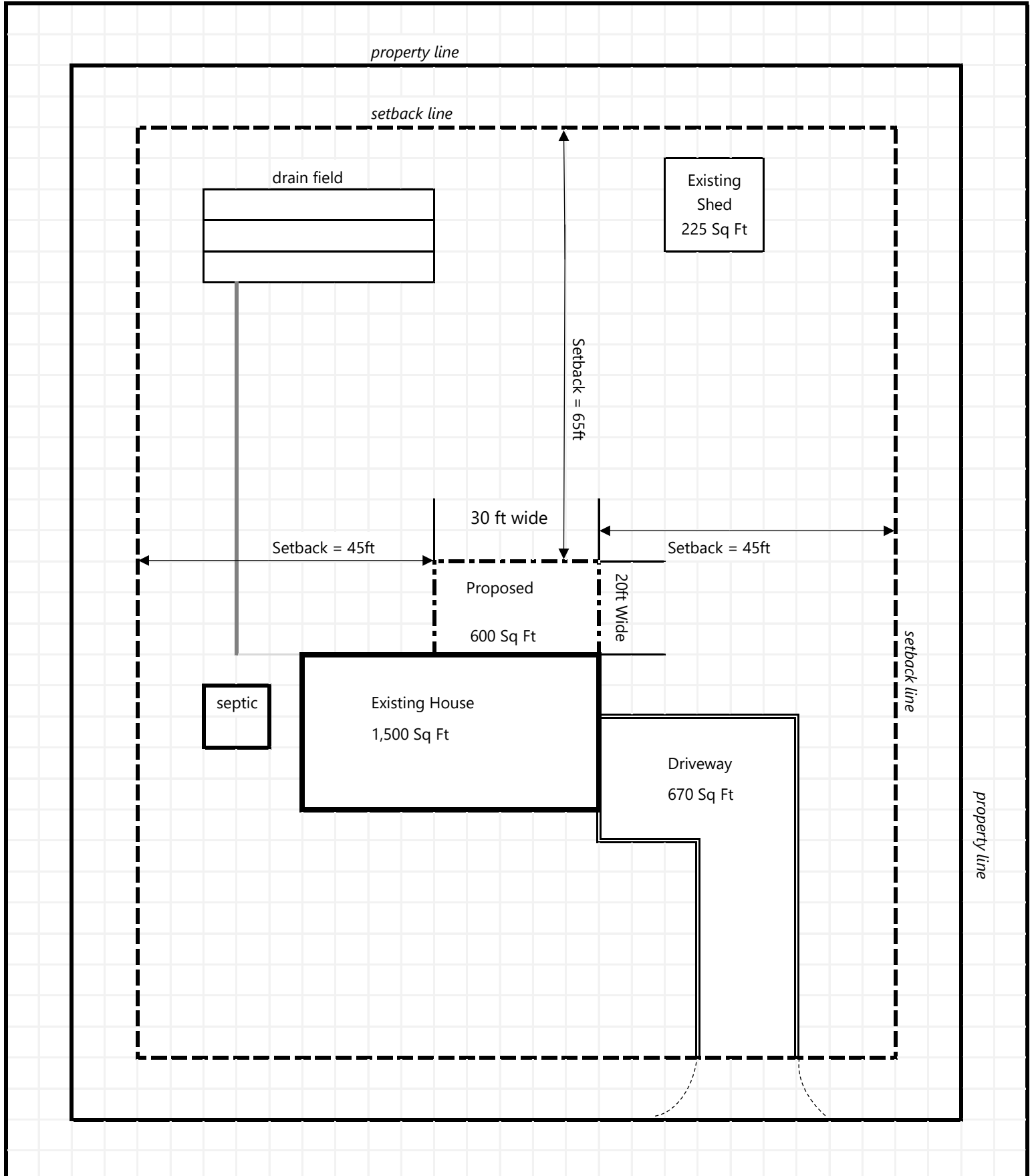

SITE PLAN EXMPLE 2

BUILDING AND ZONING PERMIT APPLICATION

Site plans provided on satellite imagery should provide as much detail as possible and show the whole lot/parcel

Site plans need to show at a minimum the following

- 1 Proposed work area
- 2 Property lines
- 3 Setback lines and information
- 4 Size of all existing and proposed structures
- 5 Lot coverage in square feet
- 6 Lot size

It is recommended that Dauphin County Parcel Viewer or another reliable and current imagery provider, such as Google Maps, be used for site plans

